

# HIP SYSTEMS

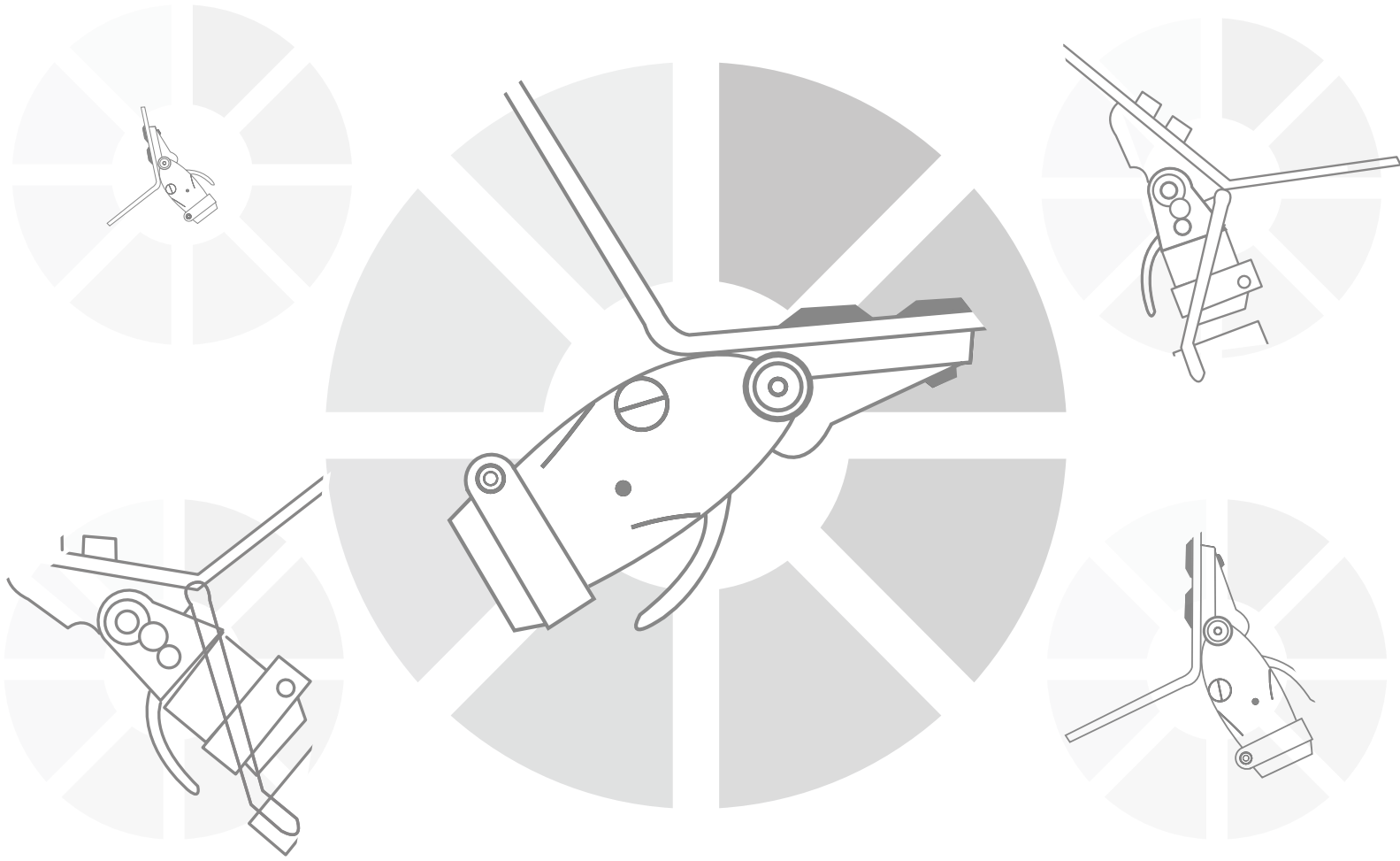

## SECTION 2

SECTION	PAGES
2A Adult Hip Joints.....	01
2B Child's Hip Joint.....	02



**DAW**  
**INDUSTRIES**

© Copyright 2015, DAW Industries, San Diego, CA. All Rights Reserved.

Orders (800) 252-2828 • Technical Hotline (877) 242-2423 • [www.daw-usa.com](http://www.daw-usa.com)



# HIP SYSTEMS

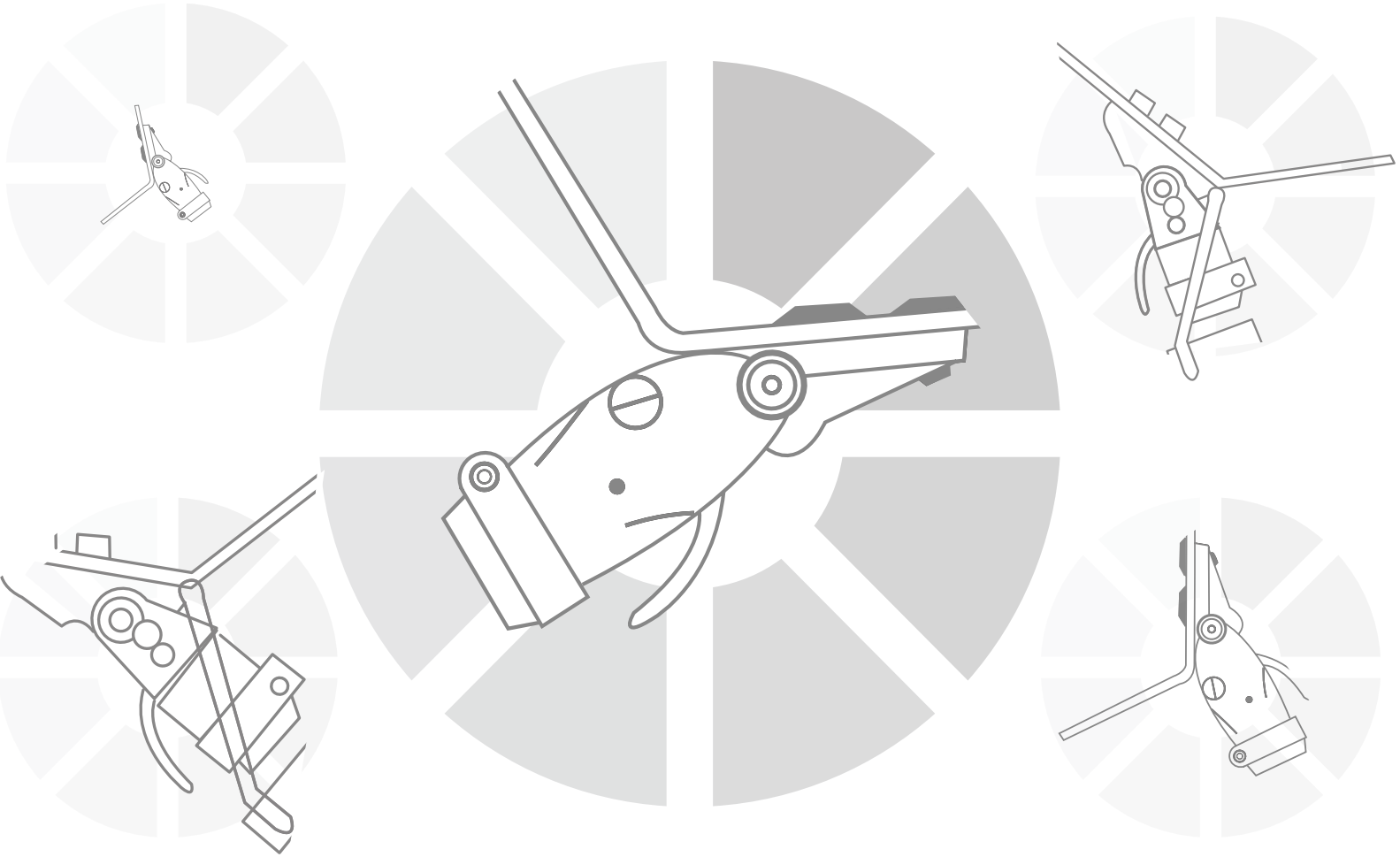

## SECTION 2

SECTION	PAGES
2A Adult Hip Joints.....	01
2B Child's Hip Joint.....	02



ADULT HIP JOINTS

TGH-Ø1 Graph-Lite™ G

TH-Ø1 Aerospace Aluminum AA

FLEXION LOADED WITH OPTIONAL MANUAL LOCK



Claim to fame

- Ultra-light graphite construction (TGH-Ø1 only)
- Smooth ball bearing action
- Excellent cosmesis
- Optional Manual Lock
- Adjustable Internal Extension
- Comfortable sitting without interference
- Ultimate in strength and dependability

This ultra-light graphite hip joint provides the ultimate durability, dependability and security for the active amputee. A unique spring-loaded mechanism allows up to 20° of hip flexion providing a smooth uninhibited gait while ambulating with a locked hip. For the more active individual, the manual lock can be disengaged. The resulting freedom of hip movement, enhanced by the extension assist, ball bearing axis and internal extension assist, produces a smoother, natural, more comfortable gait.

**What else do I need?**

• Top of knee Connectors & Alignment Systems . . . . .	Please refer to chart on back
• Pylon: (Ø 30mm). . . . .	Section 5A p.01
• Ankles: . . . . .	Section 6A p.01
• Feet: . . . . .	Section 7A p.01
• Foam Covers: – 1-part Foam Cover . . . . .	Section 9.1A p.01
– Discontinuous 2-part . . . . .	Section 9.1A p.04
• Skin and other finishings: . . . . .	Section 9.2 p.01

**Technical Data**

	TGH-Ø1	TH-Ø1
Hip Weight: . . . . .	22 oz (616 g)	26 oz (728 g)
Patient Weight Limit: . . . . .	220 lbs (100 kg)	200 lbs (90 kg)
Pylon Diameter: . . . . .	30 mm	30 mm

AA = Aerospace Aluminum  
G = Graph-Lite™



DAW INDUSTRIES



ADULT HIP JOINTS

**TGH-Ø1** Graph-Lite™ **G**

**TH-Ø1** Aerospace Aluminum **AA**

**FLEXION LOADED**  
WITH  
**OPTIONAL MANUAL LOCK**

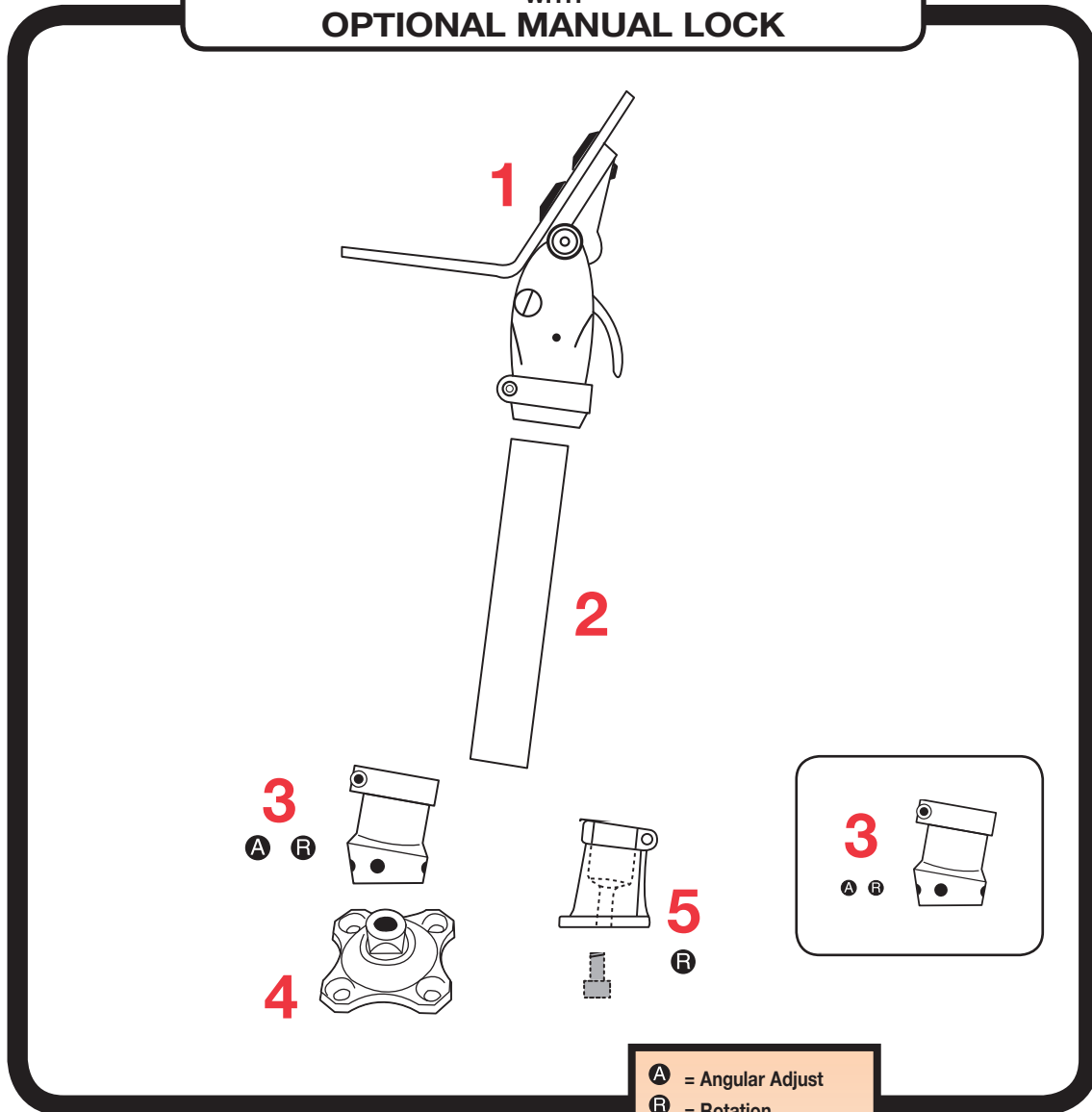

**STOCK NUMBERS**

1. TGH-Ø1.....	<b>G</b>	4. GUPS-M4H .....	<b>S</b>
TH-Ø1.....	<b>AA</b>	5. TGC-ØA .....	<b>G</b>
2. TTT-17.....	<b>A</b>	TKC-ØA .....	<b>AA</b>
3. GUPT-FCLAMP-ANG	<b>T</b>		

<b>A</b>	= Angular Adjust
<b>R</b>	= Rotation
<b>S</b>	= Slide Adjust
<b>A</b>	= Aluminum Alloy
<b>AA</b>	= Aerospace Aluminum
<b>F</b>	= Foam
<b>G</b>	= Graph-Lite™
<b>P</b>	= Plastic
<b>S</b>	= Stainless
<b>T</b>	= Titanium
<b>W</b>	= Wood



**DAW INDUSTRIES**





# CHILD'S HIP JOINT TCH-Ø1

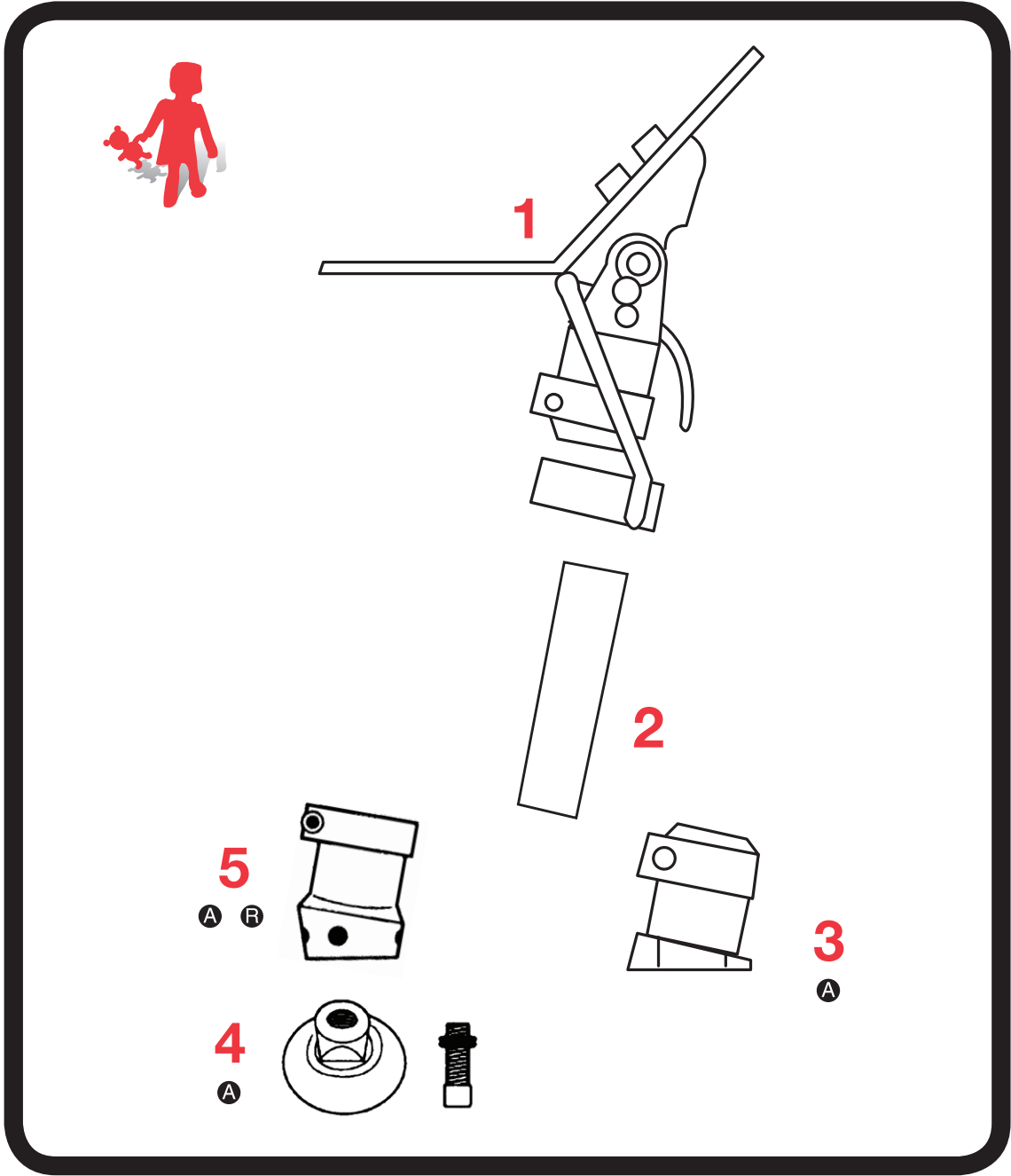

**STOCK NUMBERS**

1. TCH-Ø1 .....	AA
2. TTC-15 .....	A
3. TKC-CA .....	AA
4. GUPAC-MP1 .....	A
5. GUPAC-FCLAMPANG .....	A

<b>A</b>	= Angular Adjust
<b>R</b>	= Rotation
<b>S</b>	= Slide Adjust
<b>A</b>	= Aluminum Alloy
<b>AA</b>	= Aerospace Aluminum



**DAW  
INDUSTRIES**

