



4P10™ KD Knee (TKG-4P10)

A High-Strength, K3 4-Bar Knee Specifically Designed for KD Amputees.

Known by Prosthetists and Amputees as “Bulletproof” for its proven ability to withstand years of extreme impact from even the most active Amputees. The lite-weight but incredibly durable carbon fiber frame, robust steel linkages and smooth stainless-steel ball bearings will continue to provide safe, variable cadence gait long after the warranty period has ended.

True-KD™ Biomechanics not only serves your KD Amputee’s unique cosmetic needs. True-KD knees are also engineered to maximize stability & efficiency by exploiting a KD Amputee’s distinct biomechanical advantage!

Primary benefits:

- ✓ The tibial section tucks neatly under the socket for maximum comfort in cars, buses, and airplanes.
- ✓ Newly re-engineered DAW Pneumatics™ enable finer control of heel rise and extension dampening and require near-zero Amputee energy expenditure.
- ✓ Ultra-Lite, high strength carbon fiber construction.
- ✓ Safe, natural toe-clearance in swing for added efficiency.
- ✓ Separate extension / flexion pneumatic dampening adjustments.

Suggested K3 L-Codes* **L5840** **L5850**

Suggested K4 L-Codes* **L5840** **L5850** **L5930**

(See Full Suggested Coding Statement on pg. 53)

Complete Info & Images @ daw-usa.com

Knee Specifications:

Stock Number	TKG-4P10
Functional Level	K3 / K4
Amputation Level	Knee Disarticulation or Long TF
Weight Limit	275lb (125kg)
Knee Weight	2.4lb (1085g)
Construction Material	Carbon Graphite
Build Height	(See Next Page)
Stability Controls	Adjustment Geometric Lock & True-KD™ Polycentric Stability
Swing Controls	Separate Pneumatic Extension / Flexion Dampening & Extension Assist Adjustment
Maximum Flexion Angle	Approx. 140°
Proximal Connection	M6 4-Hole Pattern or Single Hole for 7/16 Bolt (See Selector Chart, Next Page)
Distal Connection	30mm Tube Clamp
Warranty	2 years included, Upgrade for an Additional 3 Years

Order Includes:

- 1x Swing Adjustment Wrench
- 1x Washer & Lock Washer Set
(for KD Adapter Attachment)
- 1x Practitioner’s Manual
- 1x Suggested L-Codes Letter

Recommended Foot:



**K3 Pro-Action™ Foot
w/ Multi-Axial Ankle**

Full info on page 64

Recommended Rotator:



Lo-Pro Rotator™

Proximally Attach ANY
4-Hole Connector

Full info on page 82

4P10™ KD Knee

Proximal Attachments Selector Chart

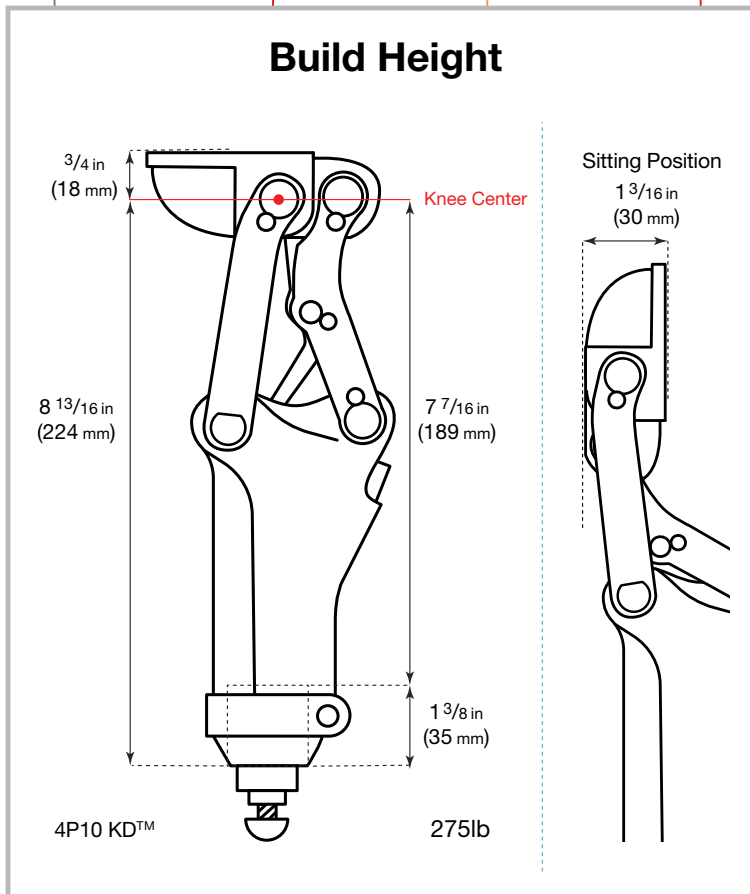
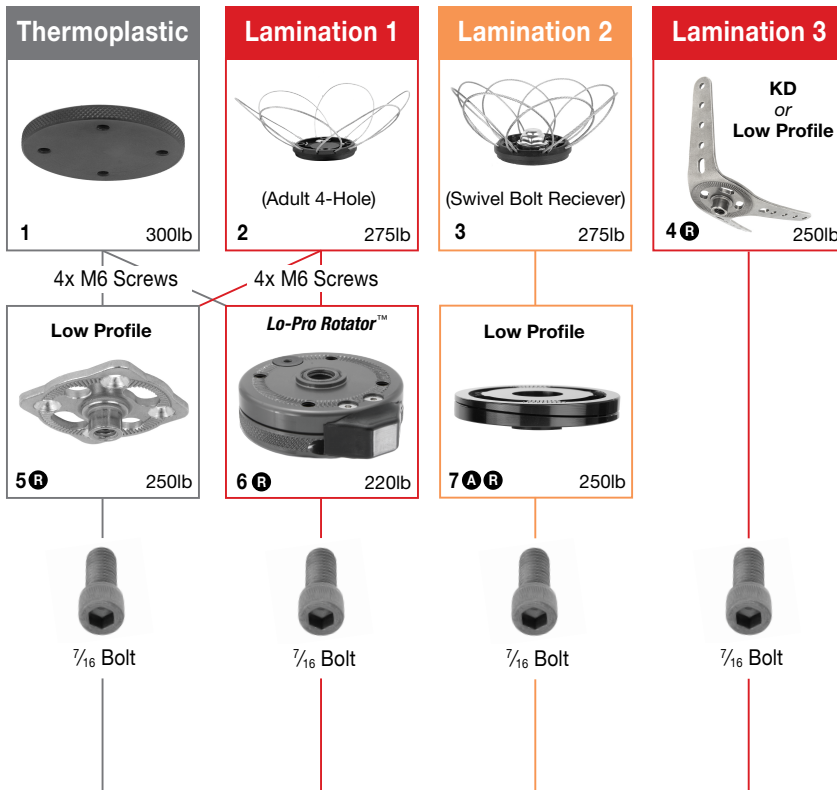

	STOCK	MATERIAL	FULL INFO
1	TSC-T	A	Pg. 75
2	TSC-BX	AA	Pg. 73
3	TSC-A	AA	Pg. 72
4	TSC-KDL	S	Pg. 72
5	TSC-PSDS	S	Pg. 83
6	TKR-01	A	Pg. 82
7	TWP-A2A	AA	Pg. 82

MATERIALS
A = Aluminum Alloy
AA = Areospace Aluminum
C = Carbon Graphite
S = Stainless Steel
T = Titanium

ADJUSTABILITY
A = Angular
R = Rotational
S = Sliding