



# SLK Multi-Matrix 2.5™ KD Knee (TGK-5PS10SLKMTX)

## PDAC Approved for Microprocessor Swing and Stance!

### Self-Learning Technology:

The SLK Multi-Matrix 2.5 Knee utilizes Self-Learning Technology to self-program and continually self-adjust as the Amputee's gait progresses. The Prosthetist simply selects the preferred "Matrix," then allows the knee to program itself as the Amputee walks.

### The Function of the Microprocessor:

The SLK Multi-Matrix 2.5 employs 2 types of sensors. One sensor measures the precise flexion/extension speed and angle. The other sensor, a 3-Dimensional gyroscopic sensor, detects the acceleration/deceleration of even the slightest movements in any direction in space. Instantly gathering data from this dual sensor system enables the Microprocessor to accurately recreate natural biomechanical gait based on the unique walking pattern of the Amputee. Contrary to other MPKs, the Self-Learning Knee (SLK) will forever continue adjusting to the progression in the Amputee's gait.

### Primary benefits:

- ✓ Provides Cosmetic Evenness in Seated Position.
- ✓ 1-Step Programming.
- ✓ Intelligent Variable Cadence.
- ✓ Natural Polycentric Toe-Clearance in Swing.
- ✓ Custom-ICR™ Geometric Stability Adjustment.
- ✓ Ultra-Lite Carbon Fiber Construction.
- ✓ Precise Adjustability of Stance Flexion Stability.



Complete Info & Images @ [daw-usa.com](http://daw-usa.com) PDAC Approved L-Codes: **L5613** **L5845** **L5848** **L5856**

### Knee Specifications:

Stock Number	TGK-5PS10SLKMTX
Functional Level	K3 or K4
Amputation Level	Knee Disarticulation
Weight Limit	275lb (125kg)
Knee Weight	2.7lb (1227g)
Construction Material	Carbon Graphite
Build Height	(See Next Page)
Stability Controls	Microprocessor Controlled Stance, Custom-ICR™ Stability Adjustment & Stance Flexion Stability Adjustment
Swing Control	Microprocessor Controlled Swing
Maximum Flexion Angle	Approx. 135°
Proximal Connection	M6 4-Hole Pattern or Single Hole for 7/16 Bolt (See Selector Chart, Next Page)
Distal Connection	30mm Tube Clamp
Warranty	2 years included, Upgrade for an Additional 3 Years

### Order Includes:

- 1x Bluetooth Remote
- 1x Charging Cable
- 1x Practitioner's Manual
- 1x Suggested L-Codes Letter

### Recommended Foot:



**K3 Pro-Action™ Foot  
w/ Multi-Axial Ankle**

Full info on page 64

### Recommended Rotator:



**Lo-Pro Rotator™**

Proximally Attach ANY  
4-Hole Connector

Full info on page 82



Orders (800) 252-2828 • Technical Support (800) 242-8669 • [www.daw-usa.com](http://www.daw-usa.com)

# SLK Multi-Matrix 2.5™ KD Knee

## Proximal Attachments Selector Chart

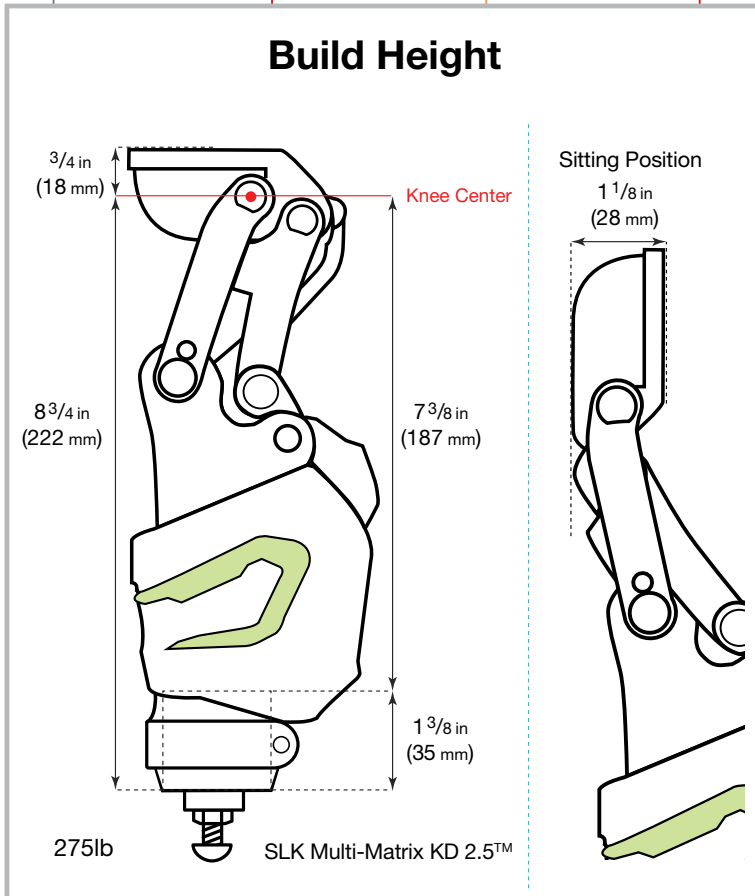
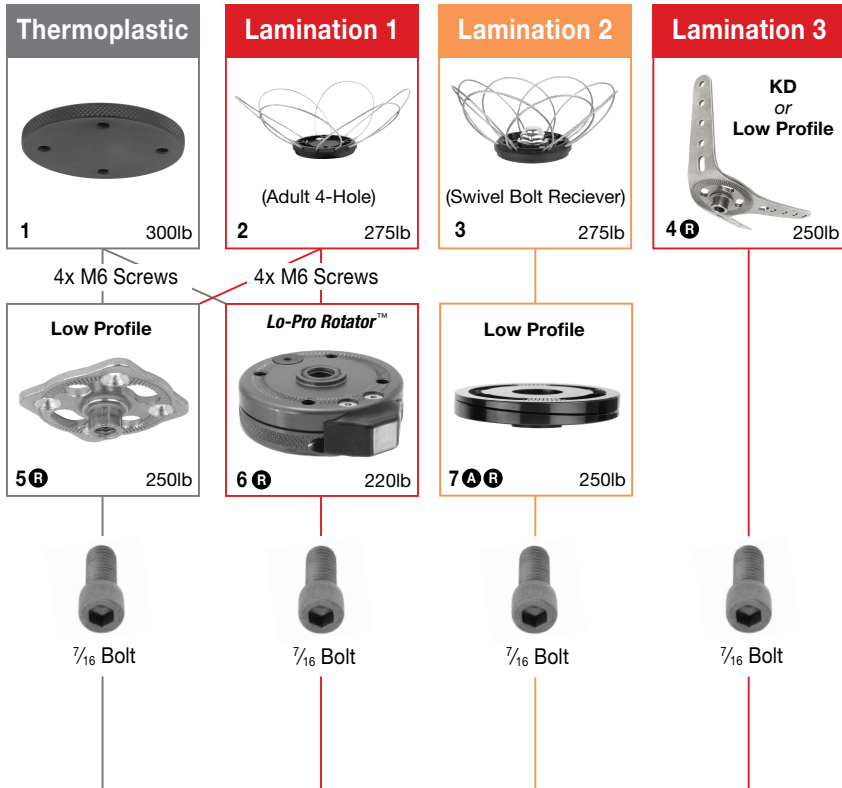

	STOCK	MATERIAL	FULL INFO
1	TSC-T	<b>A</b>	Pg. 75
2	TSC-BX	<b>AA</b>	Pg. 73
3	TSC-A	<b>AA</b>	Pg. 72
4	TSC-KDL	<b>S</b>	Pg. 72
5	TSC-PSDS	<b>S</b>	Pg. 83
6	TKR-01	<b>A</b>	Pg. 82
7	TWP-A2A	<b>AA</b>	Pg. 82

MATERIALS
<b>A</b> = Aluminum Alloy
<b>AA</b> = Aerospace Aluminum
<b>C</b> = Carbon Graphite
<b>S</b> = Stainless Steel
<b>T</b> = Titanium

ADJUSTABILITY
<b>A</b> = Angular
<b>R</b> = Rotational
<b>S</b> = Sliding